

# ROOSEVELT PHASE V PLANNING UPDATE / MAY 14-15, 2024

# PROJECT GOALS



## INCREASE CAPACITY

- + From existing capacity to 1700 total student capacity to be more aligned with 2017 Ed Spec

## OTHER NEEDS

- + Existing conditions assessment and user interviews to inform the planning process
- + Athletics upgrades are a separate scoping process included in bond planning

## OTHER CONSIDERATIONS

- + Equity
- + Safety & Security
- + Design Cohesiveness



# TIMELINE / ESTIMATED

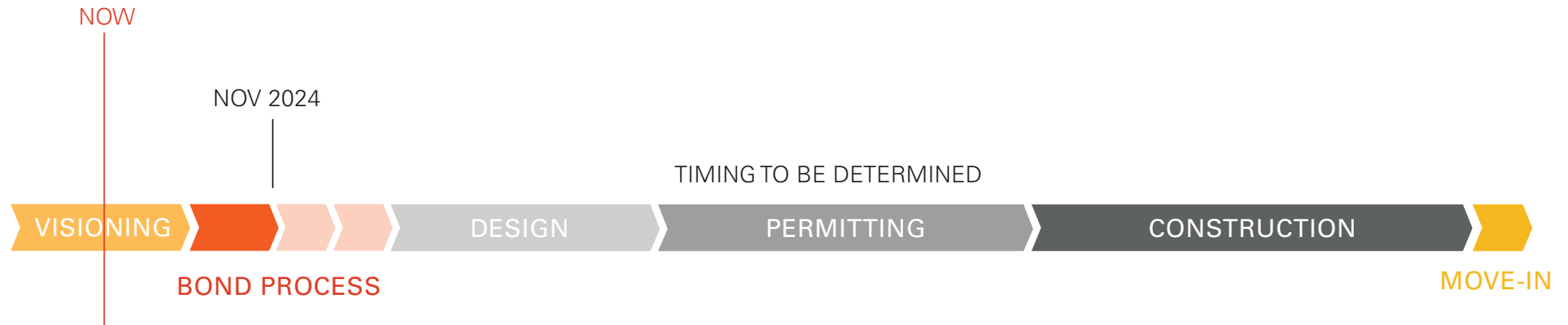

ROOSEVELT PHASE 5 - ADDITIONAL CAPACITY

## NEXT STEPS

- + Receive further feedback from stakeholders
- + Incorporate appropriate option and recommendations into Planning Report
- + Submit recommendation to Board of Education



# OVERVIEW / SITE PLAN

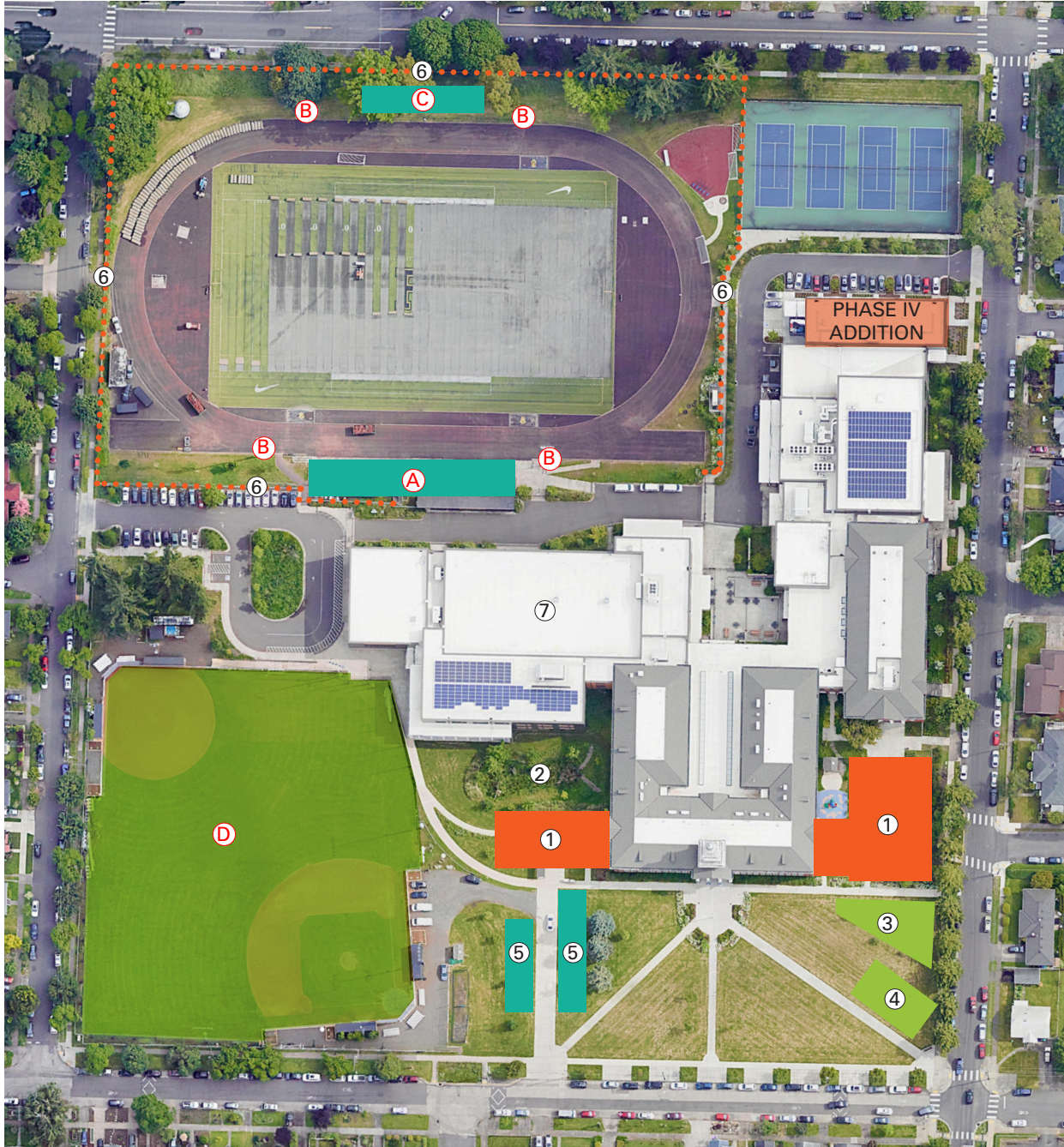

- ① POTENTIAL BUILDING ADDITION
- ② ENLARGED STORMWATER FACILITY
- ③ RELOCATED STORMWATER FACILITY
- ④ RELOCATED MEMORIAL GARDEN
- ⑤ RELOCATED BICYCLE PARKING
- ⑥ IMPROVED SECURITY FENCING
- ⑦ INCREASED SOLAR PANEL CAPACITY

## ADDITIONAL FUTURE IMPROVEMENTS (SEPARATE SCOPE)

- Ⓐ GRANDSTAND & CONCESSION BUILDING REPLACEMENT
- Ⓑ FIELD LIGHTING REPLACEMENT
- Ⓒ BLEACHER REPLACEMENT
- Ⓓ FIELD TURF REPLACEMENT

ROOSEVELT HIGH SCHOOL - TEACHING SPACES OVERTIME					
	PPS ED SPEC 1,700 CAPACITY	AFTER RHS PHASES I-III 2017	AFTER RHS PHASE III.5 2019	AFTER RHS PHASE IV 2022	RHS PHASE V MINIMUM RECOMMENDED
General Classrooms	41	37	37	41	44
Science Labs	11	7	7	7	11
Specialized Instruction	7	11	11	12	13
PE/Athletics	3	3	3	3	3
Educational Support	2	2	2	2	2
Small Instruction	10	3	6	6	6
Total Teaching Spaces	74	63	66	71	79
Average Capacity (85% Utilization)	1,700	1,350	1,410	1,560	1,700+
Total Gross Area	281,098	249,961	249,961	261,049	~281,000

TEACHING SPACE COUNT AT OTHER MODERNIZED SCHOOLS				
	McDaniel	Lincoln	Grant	Franklin
Total Current Teaching Spaces	79	79	77	76

# CAPACITY ANALYSIS / MINIMUM PROGRAM RECOMMENDATION

PHASE V - MINIMUM PROGRAM TO MEET 1,700 CAPACITY			
AREA	QUANTITY	SF/ROOM	SF TOTAL
General Classrooms	<b>3</b>	900	2,700
Science Labs	<b>4</b>	1,500	6,000
Science Prep	2	200	400
Choir Room	<b>1</b>	1,500	1,500
Equipment & Robe Storage	1	200	200
Flex Learning			AS REQ'D
Teacher Planning			AS REQ'D
Support & Circulation			AS REQ'D

## STAKEHOLDER INPUT / OTHER THINGS WE'VE HEARD

- + More storage needed throughout school
- + Centrally located student store
- + Better visibility from admin office to entry
- + More display cases throughout campus
- + More lockers for students
- + Sinks added to more art classrooms
- + Space for Choir and/or Dance
- + Ability to secure/close-off main gym from Aux gym and other parts of the school
- + Bleachers in gym updated for easier deployment at full capacity
- + Direct access to College Career Center
- + Direct access to Head Start from exterior
- + Direct access to Health Center from exterior
- + Direct access to Food/Clothes closet from exterior
- + Better exhaust/ventilation in kiln room
- + Dedicated exhaust of laser cutters in Engineering
- + Add cord reels in Engineering classroom
- + Evaluate ventilation in Uniform Storage 173A

## WHAT ELSE?

# OPTION 1 / SINGLE ADDITION - MINIMUM RECOMMENDED PROGRAM



# OPTION 1 / MAIN FLOOR

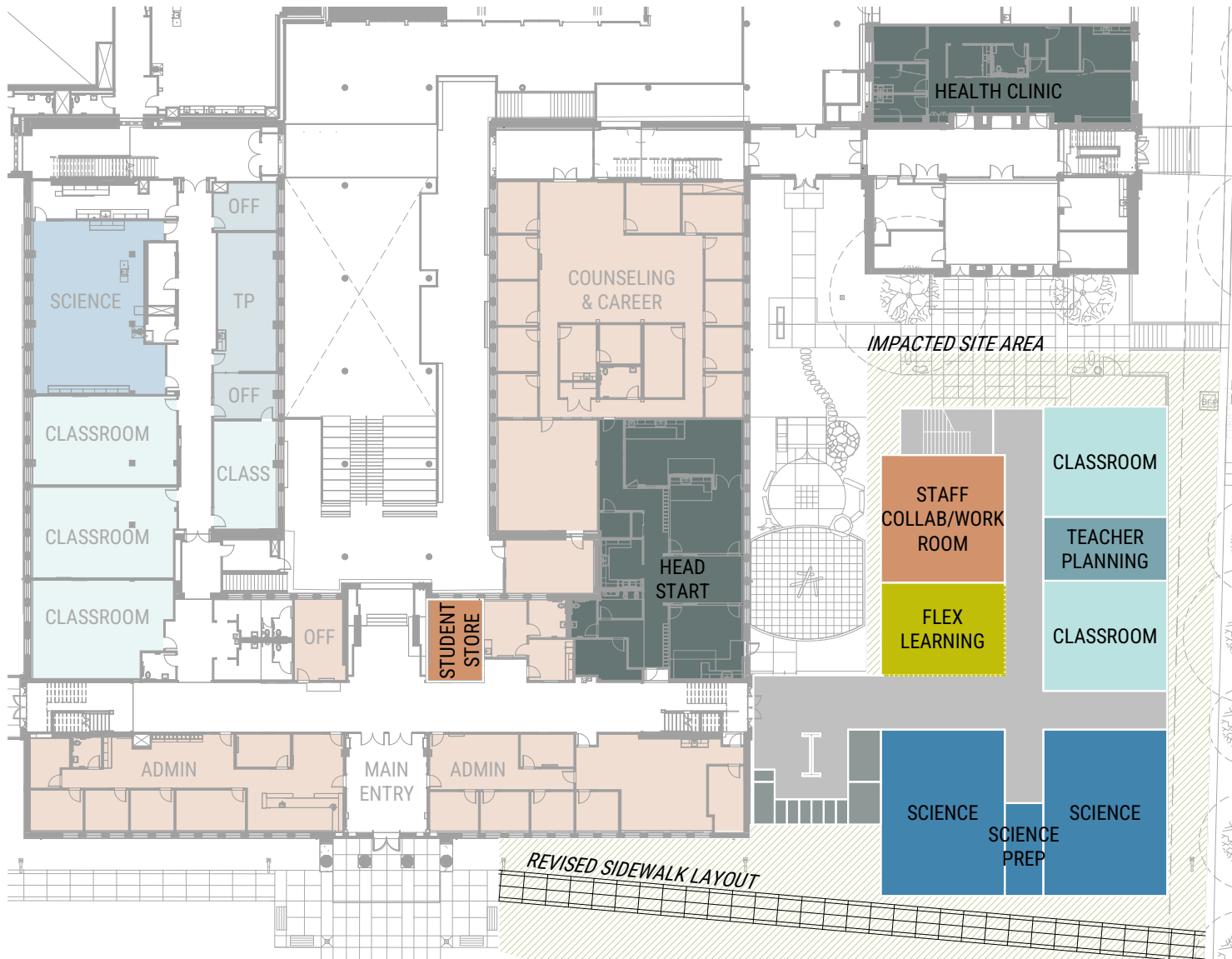

# OPTION 1 / SECOND FLOOR

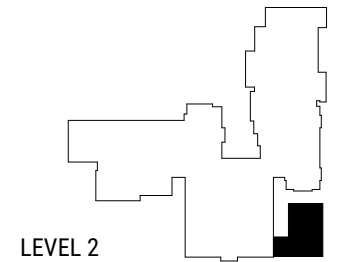
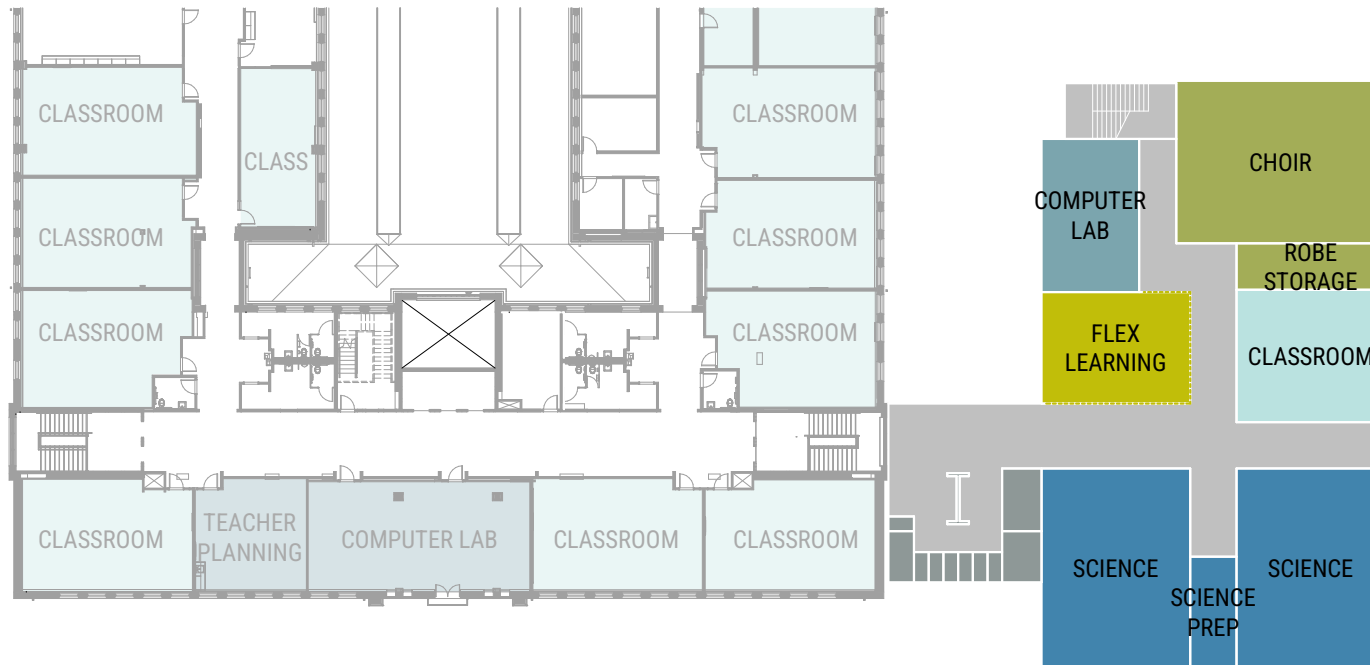

## OPTION 2 / SINGLE ADDITION - MINIMUM RECOMMENDED PROGRAM WITH HEALTH CENTER RELOCATED

# OPTION 2 / MAIN FLOOR

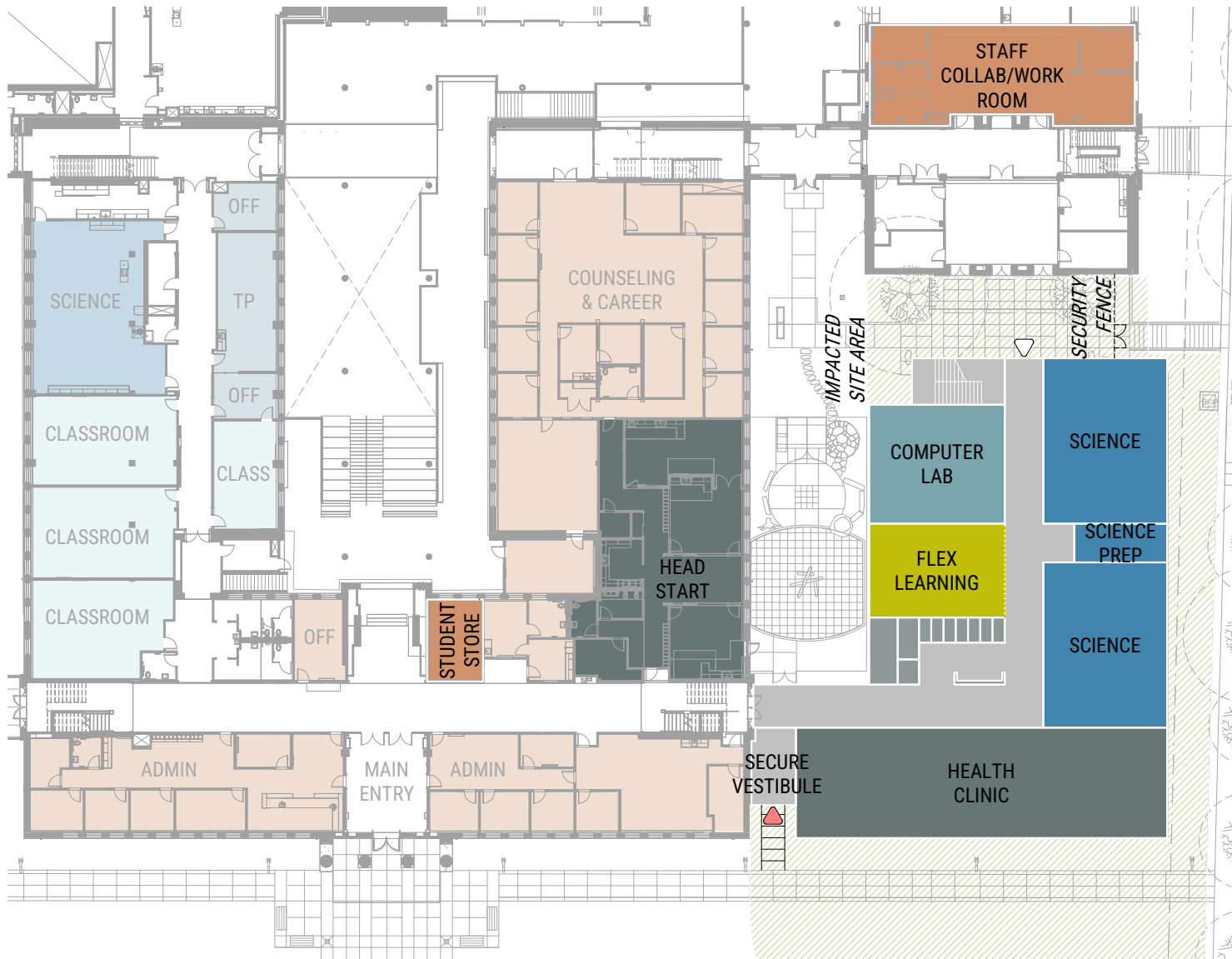



## OPTION 2 / SECOND FLOOR

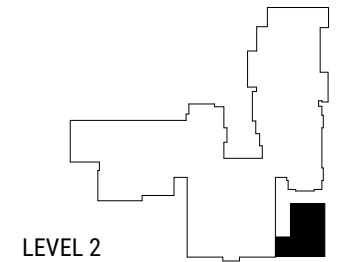
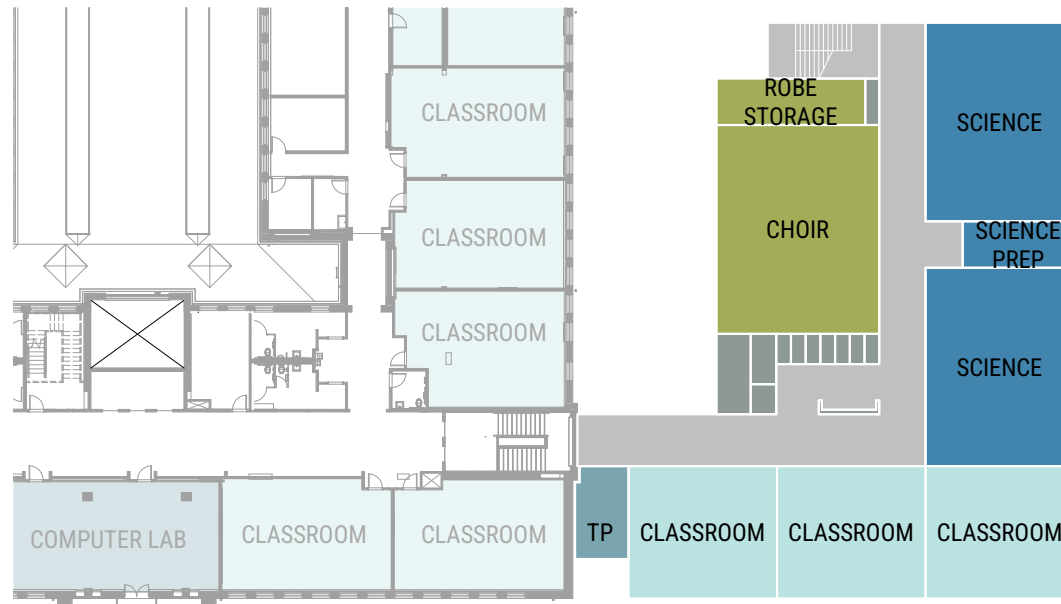

## OPTION 3 / TWO ADDITIONS - MINIMUM RECOMMENDED PROGRAM WITH HEALTH CENTER & HEAD START RELOCATED

# OPTION 3 / MAIN FLOOR

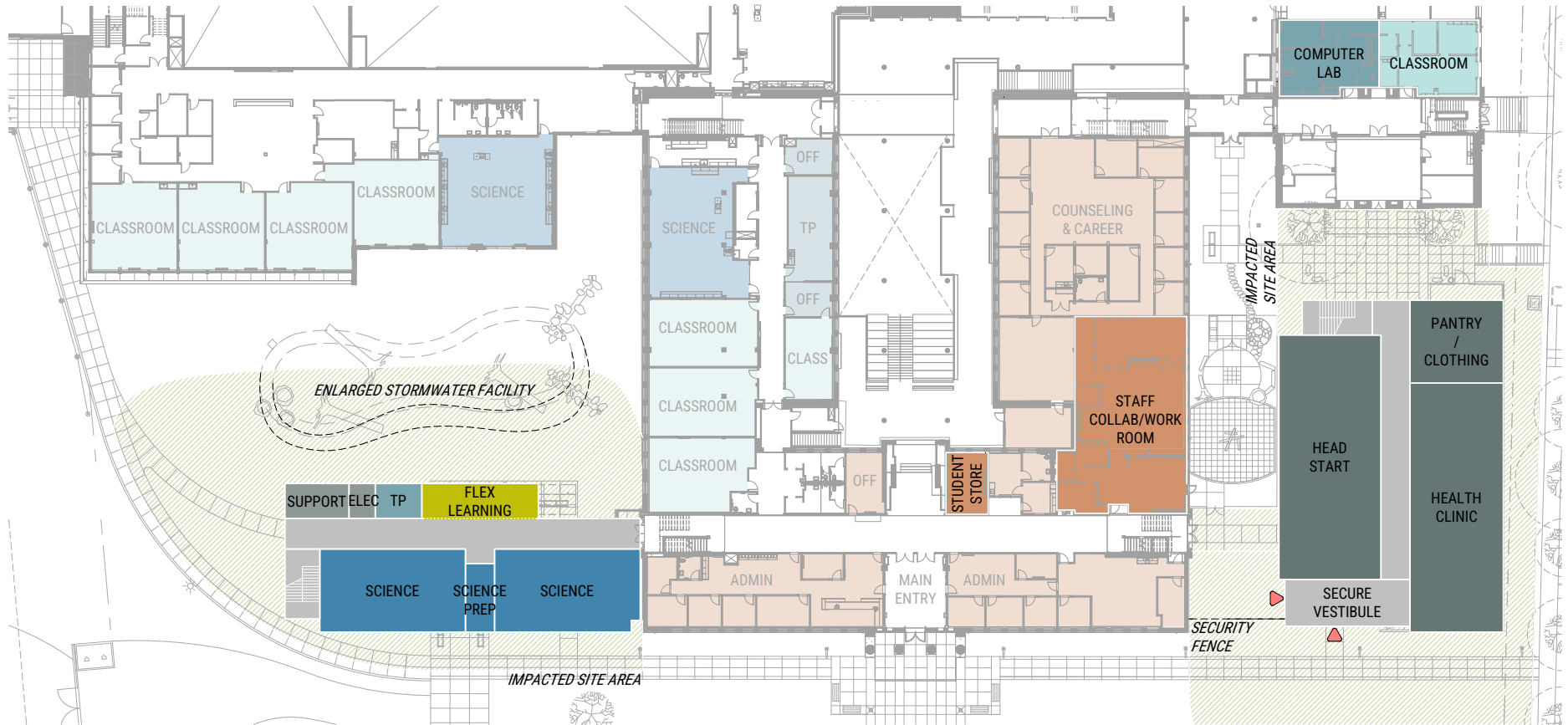

## OPTION 3 / SECOND FLOOR

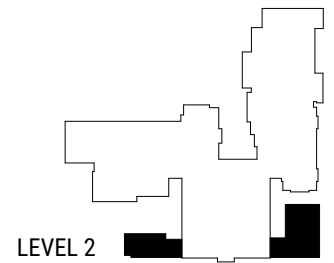
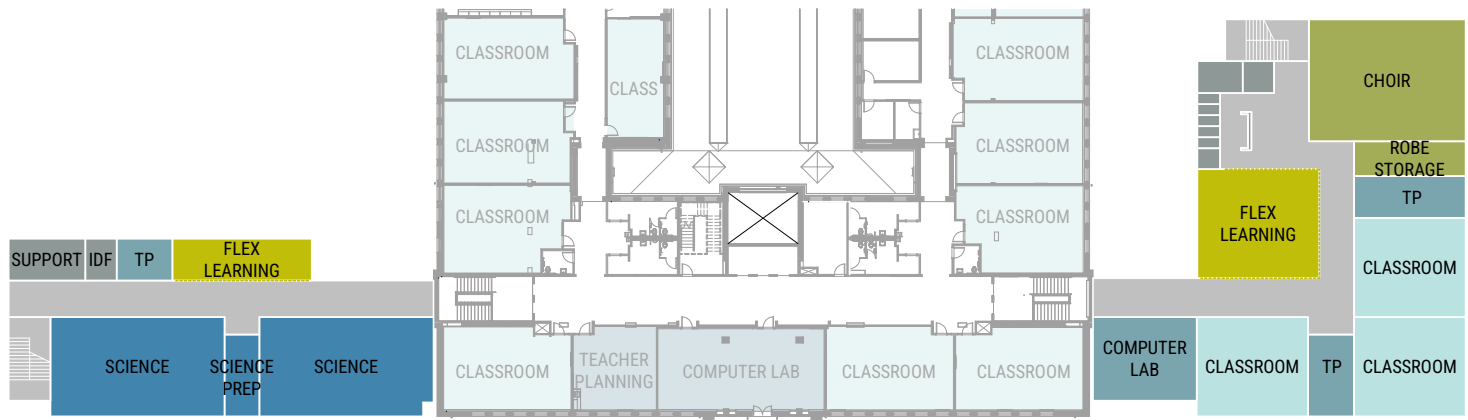



# **INPUT WORKSESSION:**

**SITE DIAGRAM  
OPTIONS BOARDS  
OTHER CONSIDERATIONS  
PRECEDENT IMAGERY**

**ANY QUESTIONS?**

THANK YOU.